

1. Instruct patient to **hold their breath for 4-5 seconds**, and then exhale into the blue **BASELINE** breath sample bag



2. Push the cap until it **clicks**



3. Prepare the test drink, close the cup **firmly** using both hands

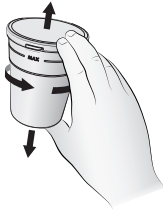

4. Mix until it is completely **dissolved**



5. Open the lid and instruct patient to **drink** the entire solution using the straw **within 2 minutes**



6. Wait **15 minutes**

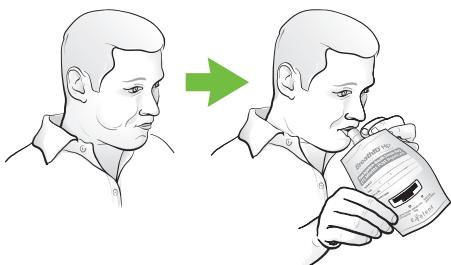

7. Instruct patient to **hold their breath for 4-5 seconds**, and then **exhale** into the gray **POST INGESTION** breath sample bag



8. Push the cap until it **clicks**



9. Place **both** breath sample bags in the provided transport bag

For detailed information regarding the step-by-step procedure, refer to the BreathID® IDkit Hp™ Two Package Insert

